

C:\Users\jacob\Documents\Projects\Sierra\2011\AIP\AIP.dwg 12/28/2011 10:56:51 AM 01/28/2011 11:01:56:51 AM Margaret Beaver

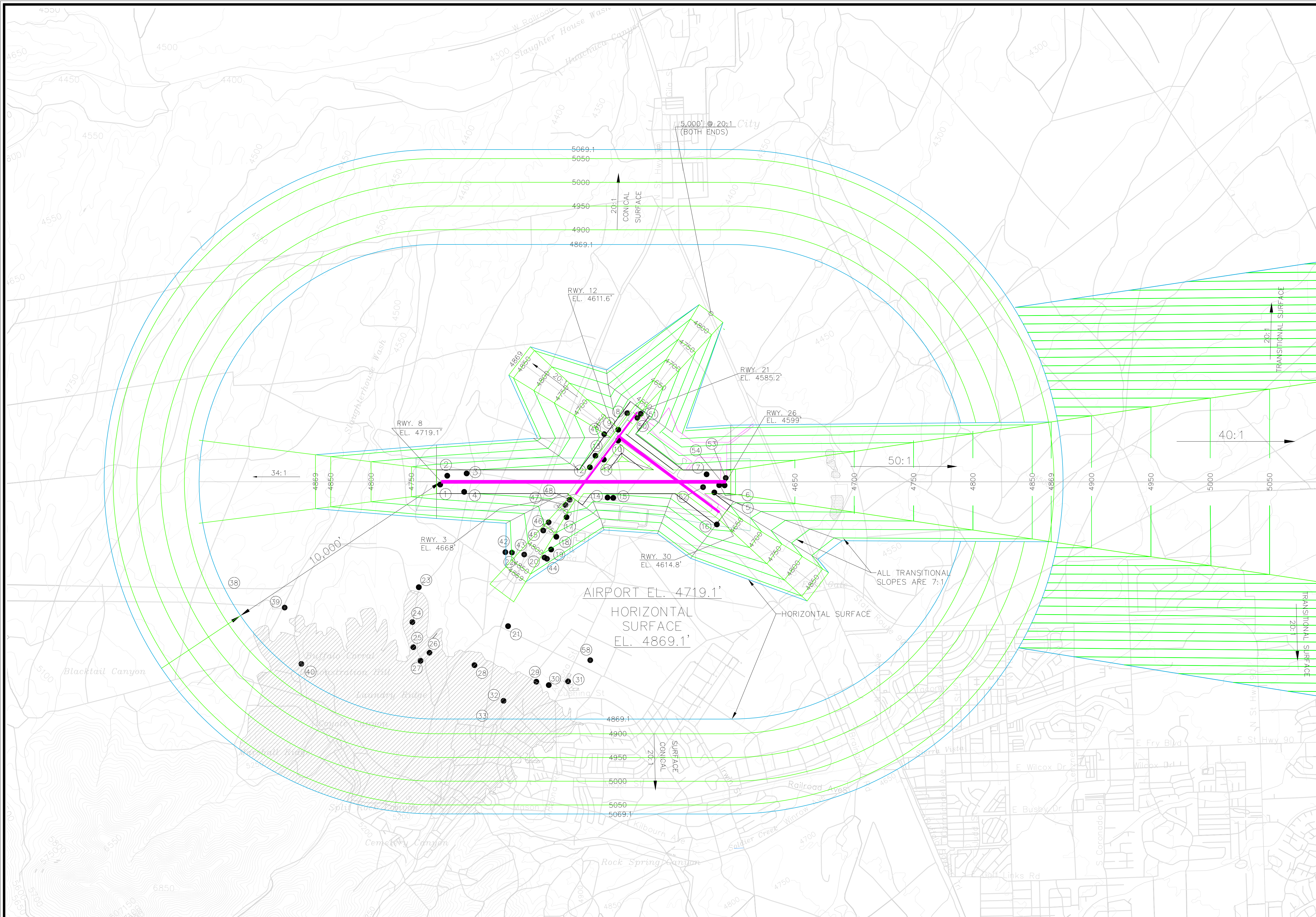

OBSTRUCTION TABLE			
Description	Elevation (MSL)	Obstruction	Recommendation
1. REFLECTOR	4730'	UP TO 11' TO THE PRIMARY SURFACE.	REQUEST FAA AERONAUTICAL STUDY
2. REFLECTOR	4723'	UP TO 19' TO THE PRIMARY SURFACE.	
3. BUSH	4722'	UP TO 1' TO THE PRIMARY SURFACE.	
4. ANTENNA	4727'	UP TO 17' TO THE PRIMARY SURFACE.	
5. ANEMOMETER	4618'	UP TO 3' TO THE PRIMARY SURFACE.	
6. WINDSOCK	4627'	UP TO 15' TO THE PRIMARY SURFACE.	
7. REFLECTOR	4610'	UP TO 6' TO THE PRIMARY SURFACE.	
8. TREE	4595'	UP TO 12' TO THE PRIMARY SURFACE.	
9. WINDSOCK	4624'	UP TO 24' TO THE PRIMARY SURFACE.	
10. SIGN	4615'	UP TO 15' TO THE PRIMARY SURFACE.	
11. SIGN	4635'	UP TO 1' TO THE PRIMARY SURFACE.	
12. WINDSOCK	4664'	UP TO 20' TO THE PRIMARY SURFACE.	
13. BUSH	4638'	UP TO 9' TO THE PRIMARY SURFACE.	
14. NDB POLE(OL)	4697'	UP TO 35' TO THE PRIMARY SURFACE.	
15. NDB POLE(OL)	4696'	UP TO 40' TO THE PRIMARY SURFACE.	
16. REFLECTOR	4618'	UP TO 6' TO THE APPROACH SURFACE	
17. TREE	4705'	UP TO 19' TO THE APPROACH SURFACE	
18. TREE	4732'	UP TO 23' TO THE APPROACH SURFACE	
19. TREE	4748'	UP TO 25' TO THE APPROACH SURFACE	
20. POLE	4770'	UP TO 36' TO THE APPROACH SURFACE	
21. POLE	4861'	UP TO 22' TO THE TRANSITION SURFACE	
22. POLE	4780'	UP TO 30' TO THE APPROACH SURFACE	
23. ANTENNA	4903'	UP TO 37' TO THE INNER HORIZONTAL SURFACE	
24. ANTENNA	4968'	UP TO 102' TO THE INNER HORIZONTAL SURFACE	
25. POLE	4997'	UP TO 131' TO THE INNER HORIZONTAL SURFACE	
26. POLE	5003'	UP TO 137' TO THE INNER HORIZONTAL SURFACE	
27. ANTENNA	5018'	UP TO 147' TO THE CONICAL SURFACE	
28. POLE	4958'	UP TO 89' TO THE CONICAL SURFACE	
29. POLE	4939'	UP TO 49' TO THE CONICAL SURFACE	
30. ROD	4934'	UP TO 39' TO THE CONICAL SURFACE	
31. ROD (OL)	4911'	UP TO 27' TO THE CONICAL SURFACE	
32. POLE	4963'	UP TO 26' TO THE CONICAL SURFACE	
33. POLE	4986'	UP TO 12' TO THE CONICAL SURFACE	
34. TREE	5165'	UP TO 72' TO THE CONICAL SURFACE	
35. TREE	5420'	UP TO 237' TO THE CONICAL SURFACE	
36. TREE	5320'	UP TO 148' TO THE CONICAL SURFACE	
37. POLE	4942'	UP TO 20' TO THE CONICAL SURFACE	
38. POLE	4919'	UP TO 76' TO THE CONICAL SURFACE	
39. POLE	4951'	UP TO 37' TO THE CONICAL SURFACE	
40. POLE	4996'	UP TO 21' TO THE CONICAL SURFACE	
41. TREE	5313'	UP TO 130' TO THE CONICAL SURFACE	
42. POLE	4797'	UP TO 29' TO THE TRANSITION SURFACE	
43. POLE	4789'	UP TO 45' TO THE APPROACH SURFACE	
44. POLE	4782'	UP TO 46' TO THE TRANSITION SURFACE	
45. TREE	4731'	UP TO 19' TO THE APPROACH SURFACE	
46. TREE	4722'	UP TO 20' TO THE APPROACH SURFACE	
47. GROUND	4683'	UP TO 7' TO THE APPROACH SURFACE	
48. GROUND	4672'	UP TO 2' TO THE APPROACH SURFACE	
49. BUSH	4621'	UP TO 5' TO THE APPROACH SURFACE	
50. BUSH	4593'	UP TO 13' TO THE PRIMARY SURFACE	
51. TREE	4592'	UP TO 12' TO THE PRIMARY SURFACE	
52. REFLECTOR	4616'	UP TO 10' TO THE PRIMARY SURFACE	
53. REFLECTOR	4598'	UP TO 2' TO THE PRIMARY SURFACE	
54. REFLECTOR	4600'	UP TO 4' TO THE PRIMARY SURFACE	
			REQUEST FAA AERONAUTICAL STUDY

OBSTRUCTION LEGEND	
• ①	OBSTRUCTION
• ①	GROUP or MULTIPLE OBSTRUCTIONS

- GENERAL NOTES:**
- Obstructions, clearances, and locations are calculated from ultimate runway end elevations and ultimate approach surfaces, unless otherwise noted.
 - Depiction of features and objects within the outer portion of the approach surfaces, is illustrated on the APPROACH ZONES PLAN Sheet 6 of these plans.
 - Depiction of features and objects within the inner portion of the approach surfaces, is illustrated on the INNER APPROACH SURFACE PLAN AND PROFILES, Sheets 7 and 8 of these plans.

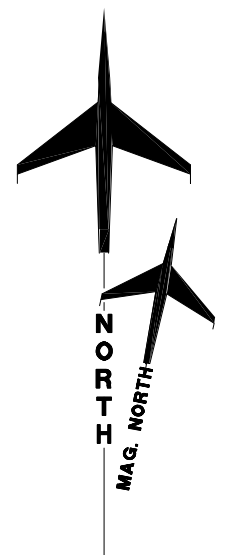
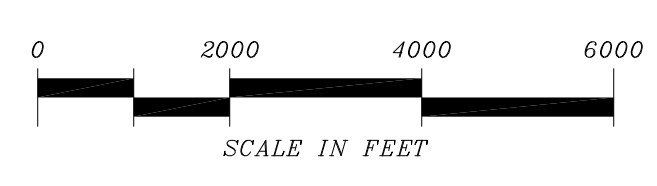

No.	REVISIONS	DATE	BY	APPD.

**SIERRA VISTA MUNICIPAL AIRPORT
LIBBY ARMY AIRFIELD
F.A.R. PART 77
AIRSPACE PLAN
SIERRA VISTA, ARIZONA**

PLANNED BY: James M. Harris P.E.
 DETAILED BY: Maggie Beaver
 APPROVED BY: James M. Harris P.E.

July 28, 2011 SHEET 4 OF 15

Goffman Associates
Airport Consultants
www.goffmanassociates.com

*THE PREPARATION OF THESE DOCUMENTS WAS FINANCED IN PART THROUGH A PLANNING GRANT FROM THE FEDERAL AVIATION ADMINISTRATION AS PROVIDED UNDER SECTION 505 OF THE AIRPORT AND AIRWAY IMPROVEMENT ACT OF 1982, AS AMENDED. THE CONTENTS DO NOT NECESSARILY REFLECT THE OFFICIAL VIEWS OR POLICY OF THE FAA. ACCEPTANCE OF THESE DOCUMENTS BY THE FAA DOES NOT IN ANY WAY CONSTITUTE A COMMITMENT ON THE PART OF THE UNITED STATES TO PARTICIPATE IN ANY DEVELOPMENT DEPICTED HEREIN NOR DOES IT INDICATE THAT THE PROPOSED DEVELOPMENT IS ENVIRONMENTALLY ACCEPTABLE IN ACCORDANCE WITH APPROPRIATE PUBLIC LAWS.